



Montaje sin tornillos
Montage sans vis ni écrous
Aufbau ohne Schrauben



Se recomienda usar martillo de goma
Recommandé utiliser un marteau en caoutchouc
Empfohlen wird ein Gummihammer



Se recomienda el uso de guantes
Nous recommandons l'utilisation de gants
Verwendung von Handschuhen wird empfohlen

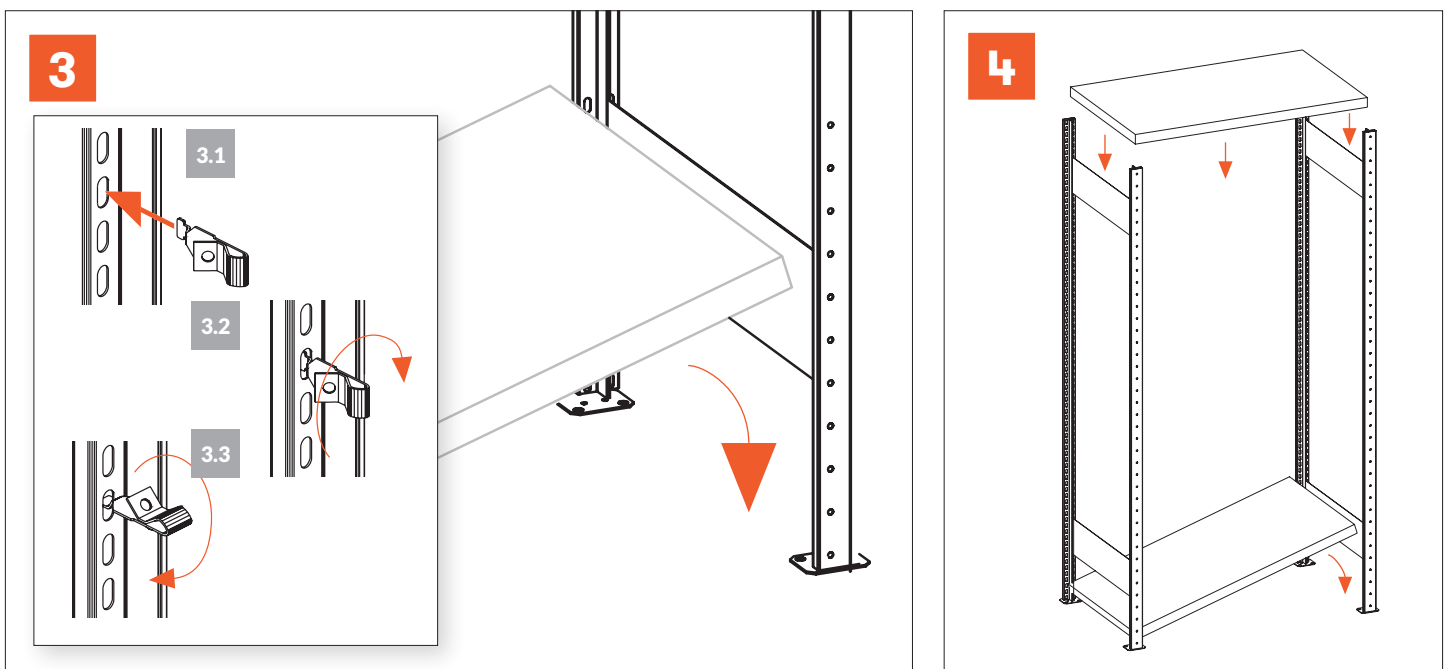
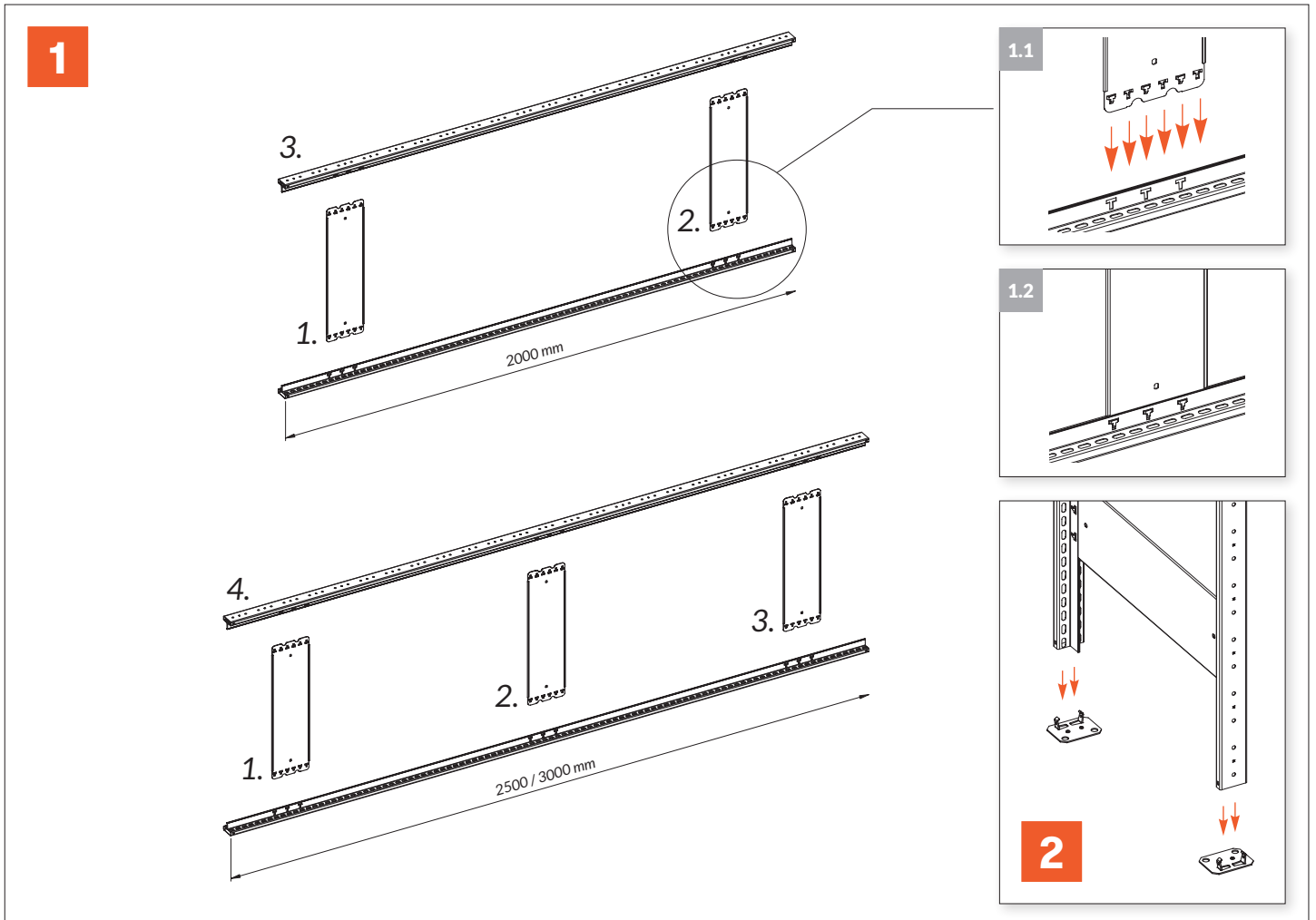

5

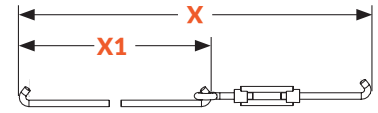
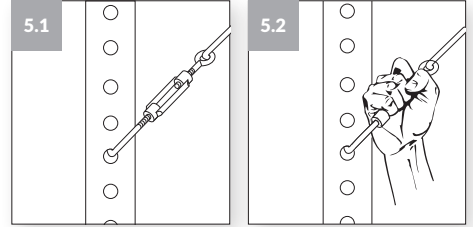
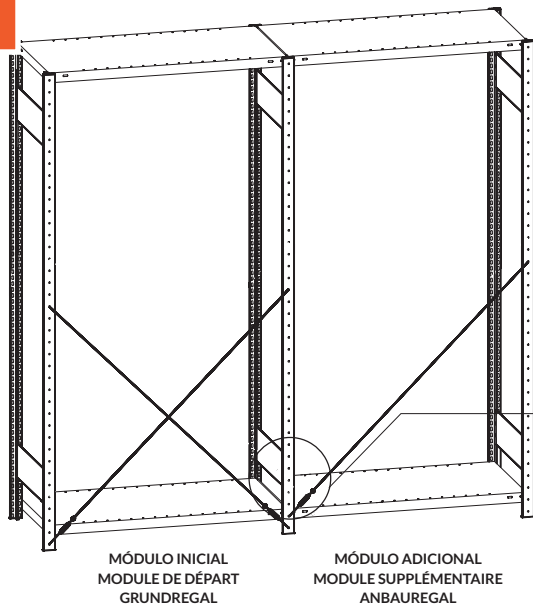

L	X	X1
1000 mm	1303 mm	1186 mm
1300 mm	1532 mm	1415 mm
1500 mm	1697 mm	1580 mm

B

(H) 2000 X (L) 1000 / 1300 / 1500 mm
 (H) 2500 / 3000 X (L) 1000 / 1300 / 1500 mm

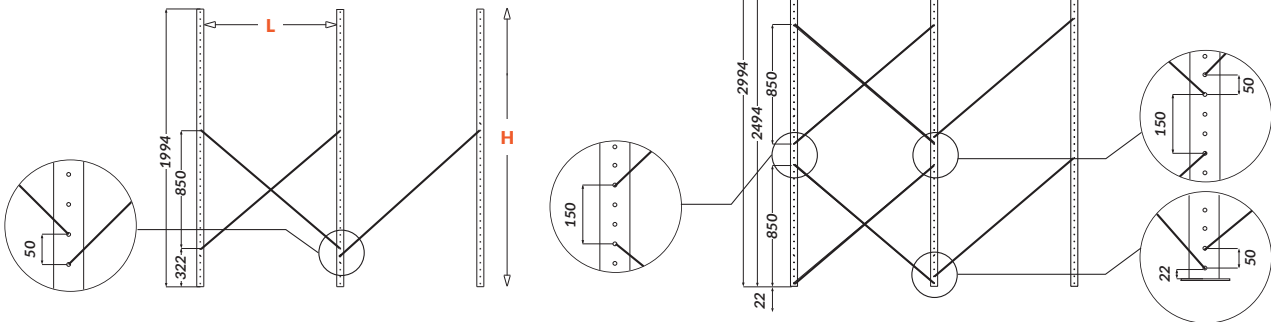

C

MÓDULO INICIAL / MODULE DE DÉPART / GRUNDREGAL
 MÓDULOS ADICIONALES / MODULES SUPPLÉMENTAIRES / ANBAUREGALE

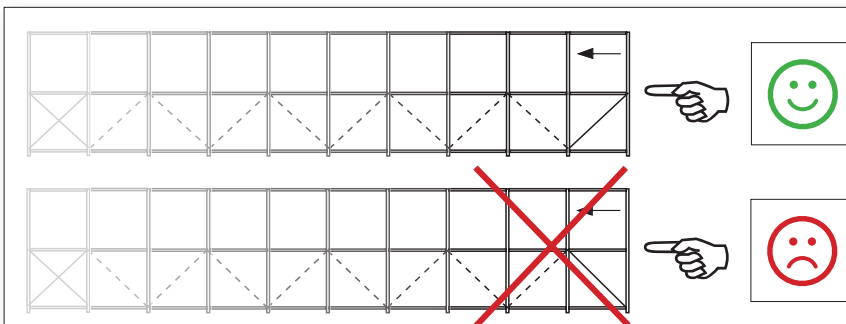
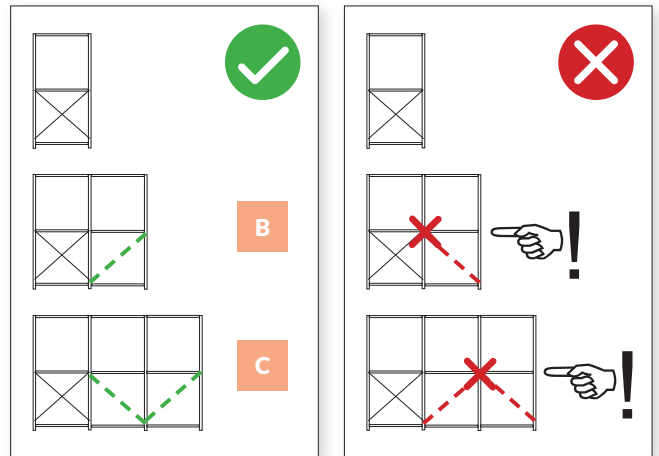
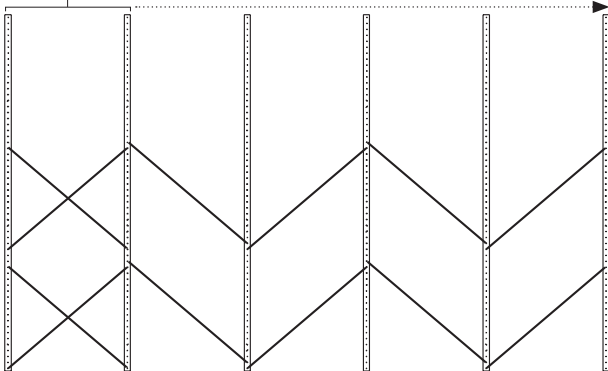

¡ATENCIÓN!
 El tensor diagonal, siempre debe ir colocado de abajo a arriba en el último módulo adicional.

ATTENTION!
 Le tenseur diagonal doit toujours être installé du bas vers le haut sur le dernier module supplémentaire.

ACHTUNG!
 Die diagonale Verstrebung muß immer von unten nach oben im letzten Anbauregal angebracht werden.